

GLEANER[®] PRODUCT MARKETING BULLETIN

BUILT WITH THE FARMER IN MIND

Date:	November 27, 2013
Bulletin Number:	GL13-10PMB
Subject:	2014 GLEANER Combines
Summary:	Feature Preview of the 2014 models for GLEANER combines
Distribution:	All Gleaner Dealers



INTRODUCTION

The following bulletin provides detailed information about the 2014 version of GLEANER combines available in the North America market. Any changes and improvements made after a model year's production begin are referred to as a "running" change. Where possible, the previous year "running" change will be listed with effective serial numbers.

Subject: 2014 GLEANER S8 Super Series Combines

SERIAL NUMBER PREFIX

The effective 2014 versions combines will begin with the following serial numbers

GLS68	AGCRS6800EHTVXXXX
GLS78	AGCRS7800EHTVXXXX
GLS88	AGCRS8800EHTVXXXX

NEW STANDARD FEATURES

The new standard features included in the base version for 2014 models are the following:

- T4F Engine
- AGCO POWER 9.8L 7-Cylinder Engine (Models S78 and S88)
- 230 Gallon Fuel Tank
- DuraGuard™ Rotor Gearbox
- Manual Rotor Reversing Tool
- Polyurethane Accelerator Rolls
- Updated Header Drive Clutch
- Tool Box and Swing Away DEF Tank
- Rear Engine Compartment Grab Handles
- Truck Tie Downs
- High Speed 3250 RPM Chopper with 24 Knives and Stationary Bed
- Plastic Spreader Paddles
- SmartCooling™ Cooling Package Standard
- Dual Hydraulic Chaff Spreader Standard

NEW IMPROVED FEATURES

The new optional features for 2014 models are the following:

- XR Transmission™
- Optional Carbide Grey Wrap

Subject: 2014 GLEANER S8 Super Series Combines

T4F ENGINE

AGCO POWER has used SCR technology since the beginning of 2009. With the T4F solution, Gleaner has introduced cEGR (cooled exhaust gas recirculation) to lower the dosing rate of the DEF fluid. This technology provides lower total fluid consumption (DEF and fuel).

All engines now feature twin turbocharging which contributes to the higher sustained horsepower and torque of these new engines.

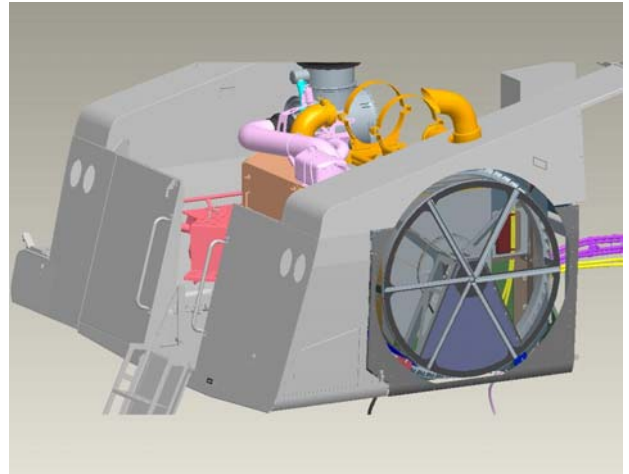

AGCO POWER 9.8L 7-CYLINDER ENGINE

The Gleaner S78 Class 7 and S88 Class 8 combines feature a new high-torque, fuel-efficient AGCO POWER 98 AWF liquid-cooled 9.8L twin-turbocharged diesel engine. These engines feature SCR clean air technology that is more efficient at high horsepower ratings. The S78 boasts a rated engine horsepower of 375 hp (279 kW) with 451 hp (336 kW) maximum boost. The S88 is rated at 430 hp (320 kW) with 471 hp (351 kW) maximum boost.

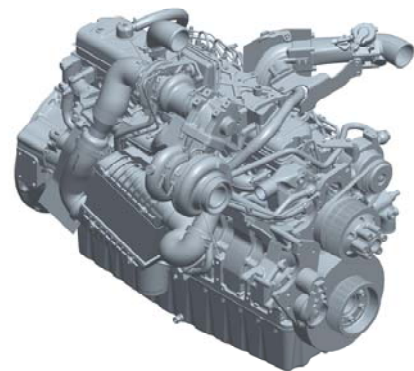

230 GALLON FUEL TANK

The Gleaner S8 Super Series has increased the fuel tank capacity by 53%. The large 230-gallon polyethylene fuel tank, protected by in-line canister style separators, ensures an adequate supply of clean fuel to feed the system. The large fuel tank module also allows for longer intervals between fuelings.

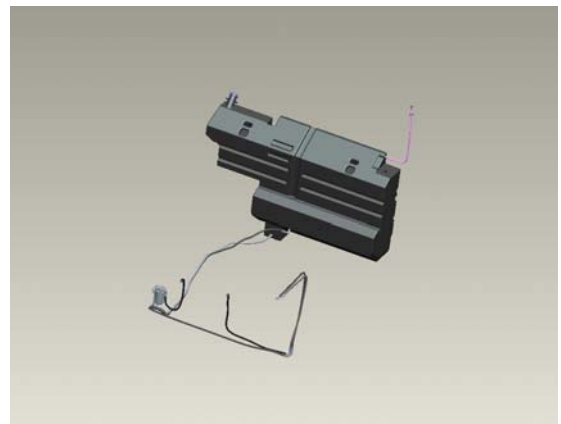

Subject: 2014 GLEANER S8 Super Series Combines

DURAGUARD™ ROTOR GEAR BOX

All S8 models feature a newly designed heavy-duty DuraGuard™ two-speed rotor gearbox with larger sheave, bearings and belt built for the higher demands of the S88 model and standard on all machines. It features a wider overlap on rotor speeds and allows operators to run on the high side of the low range in a variety of crops for maximum efficiency.



MANUAL ROTOR REVERSING TOOL

The new DuraGuard™ rotor gear box also allows for manual reversing. The manual rotor reversing tool easily attaches to the rotor gear box and engages the reversing action. This allows the operator to service the processor quickly and easily. The manual rotor reversing tool is located in the tool box when the machine is delivered.

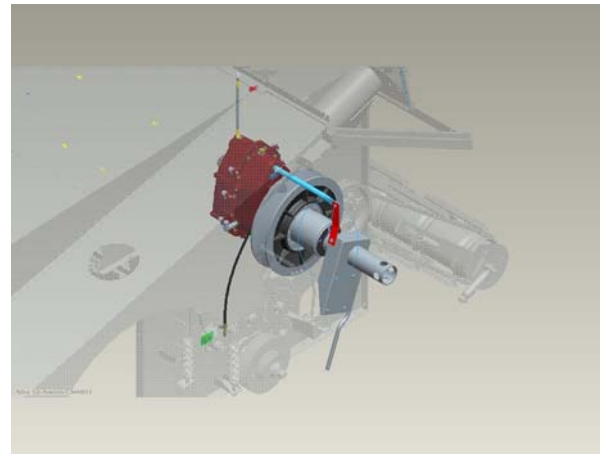

POLYURETHANE ACCELERATOR ROLLS

The Gleaner S8 Super Series 2014 model year combines will feature polyurethane accelerator rolls. The accelerator rolls are made of polyurethane versus the previous rubber material, increasing component lifespan. The new material will allow the rolls to last significantly longer than the current hard rubber lug in observed tests.

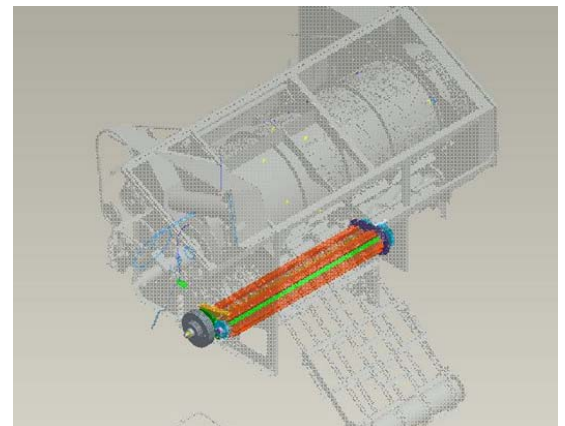

Subject: **2014 GLEANER S8 Super Series Combines**

UPDATED HEADER DRIVE CLUTCH

The newly updated header drive clutch will incorporate the main drive clutch design with common parts which will greatly increase the torque capacity of the header drive. The header drive is rated at a continuous 140 hp with an increase in the peak horsepower load rating.

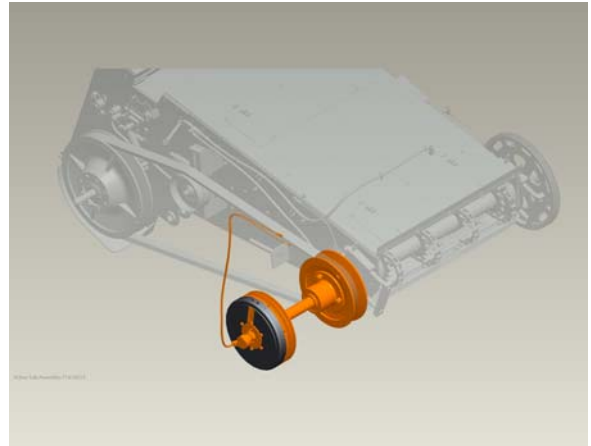

TOOL BOX AND SWING AWAY DEF TANK

The Gleaner S8 2014 models will feature a tool box located next to DEF tank for easy, ground level access. The DEF tank support is also designed to swing out away from the machine for easier access and improved serviceability.

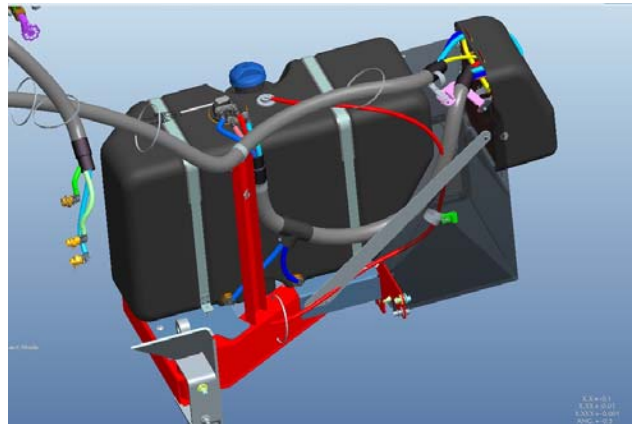

REAR ENGINE COMPARTMENT GRAB HANDLES

2014 Gleaner S8 Super Series models will all have rear engine compartment grab handles. The grab handles allow for easier access to the engine compartment as well as provide improved confidence and comfort to the operator.

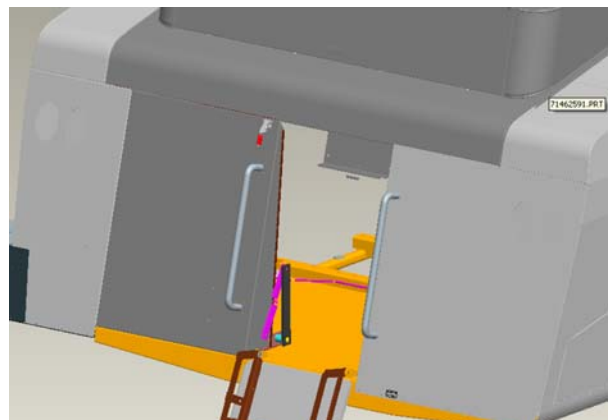

Subject: 2014 GLEANER S8 Super Series Combines

TRUCK TIE DOWNS

Truck tie downs are now incorporated into the frame of the Gleaner S8 Super Series 2014 models. These tie downs provide easier loading and unloading machines for custom harvesters or operators that need to transport the machine. The tie downs also provide more secure anchors to ensure the security and stability of the machine while transporting. There are 4 tie downs, 2 are mounted on front load member and 2 on rear on the combine mainframe.

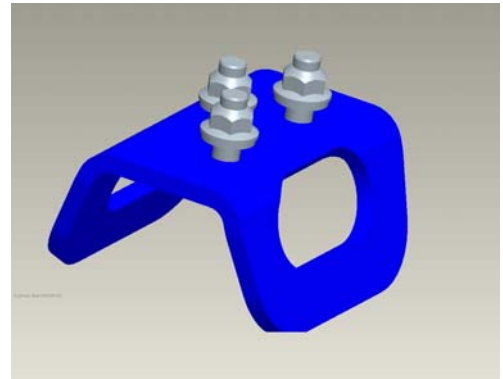

HIGH SPEED 3250 RPM CHOPPER WITH 24 KNIVES AND STATIONARY BED

The S8 combine features a completely redesigned 2-speed chopper for greater residue chopping demands when required. For high speed chopping, the smaller 7 1/2" chopper drum features 24 knives, a 50% increase from the previous chopper drum for greater chopping and a 16% increase in speed to 3250 rpm to create enough vacuum pressure to pull residue on through and keep the processor cage clean, optimizing processor performance. The new design features a taper lock hub on the top sheave versus prior key-in-shaft. Larger Timken/Fafnir bearings have also been incorporated. Knife bolts have been increased from 8mm to 10mm. Round Bearing Flangettes increase bearing support. Rounded ears alleviate stress on welds. The stationary bed features 6 adjustable lower knives for a finer cut that can be retracted if a finer cut is not required thereby reducing chopper horsepower requirements.

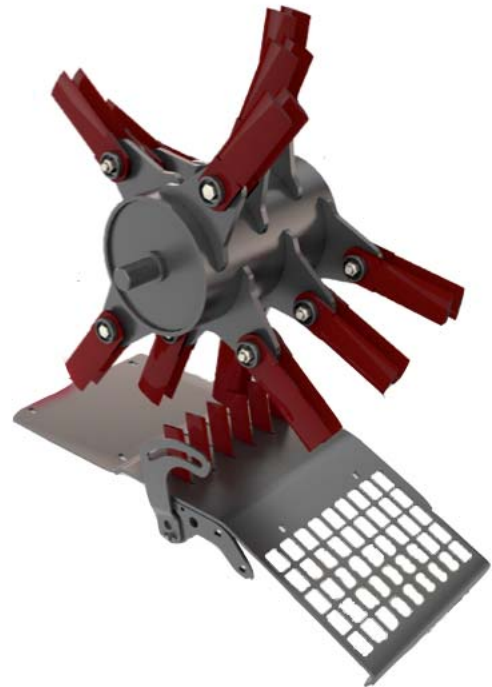

PLASTIC SPREADER PADDLES

The Gleaner S8 Super Series 2014 models have integrated plastic paddles on the hydraulic straw spreader to ensure longer wear life in comparison to the previous rubber paddles. The rigid plastic paddles also provide a more consistent distribution of material spread.

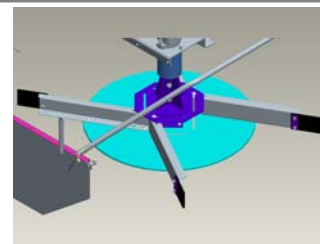

Subject: 2014 GLEANER S8 Super Series Combines

STANDARD SMARTCOOLING™ PACKAGE

All 2014 S8 models will include the variable pitch SmartCooling™ cooling package as standard.

The “Smart” system monitors key temperatures; coolant, intake air, and hydraulic oil and varies the fan pitch automatically resulting in only the necessary amount of cooling provided. The system will reduce the horsepower draw of the fan by more than 66% on an 80° F (26° C) day.

When the separator is engaged, the fan will reverse pitch at full speed rotation for five seconds every fifteen minutes to clean radiator and rotary screen. The fan then returns to an aggressive 40 degree pitch for 15 seconds to clean the engine compartment and then returns to variable to save horsepower and fuel.



STANDARD DUAL HYDRAULIC CHAFF SPREADER

The hydraulic dual chaff spreader is now standard on all 2014 Gleaner S8 Super Series models.

The standard hydraulic dual chaff spreader uses the extreme high volume air passing below the accelerator rolls to blow chaff out the back of the combine. It features an adjustable tailboard and fins to help spread the MOG into a wider swath as it leaves the machine.

The standard hydraulic dual chaff spreader on all S8 Super Series combines delivers the ultimate in chaff spreading and when used with the hydraulic straw spreader and redesigned spreader curtain, provides an even wider spread of residue for tillage, planting, and chemical applications.

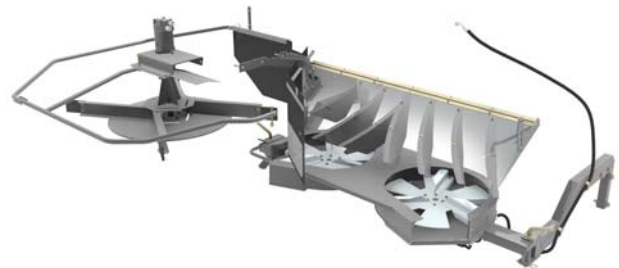

Subject: 2014 GLEANER S8 Super Series Combines

OPTIONAL XR™ TRANSMISSION

All S8 models feature an optional XR™ two-speed hydro feature that provides greater climbing ability on hills and the convenience of on-the-go shifts. The two –speed on-the-go shift is operated by a convenient push button from the right hand console. The two-speed hydro features a 30% larger hydro motor. When the rocker switch is switched to low, ground speed is reduced by 23% and torque is increased by 30%. When rocker switch is switched to high, it results in a 30% increase in ground speed.



Catalog number (factory install)

71467391

(field install - S-Series MY2011 and newer machines)

700961441

OPTIONAL CARBIDE GREY WRAP

All 2014 Gleaner S8 models feature an optional carbide grey wrap. The shielding of the Gleaner S8 Series is wrapped with a durable vinyl that will ensure the operator will stand out among the rest. The Gleaner is already the most differentiated combine in the market and the optional Carbide Grey Wrap will make sure everyone knows that it's a Gleaner in the field.

Catalog number (factory install)

S68 71468338

S78 71468337

S88 71468336

